

CAD/CAM Abutment

# Geo LA Multibase



Scan the QR code  
to visit the webpage ▶



## Features

<b>Cutting guideline</b>	Height is editable on Geo Library	<b>Two screws</b>	TiN coating screw & Anodized titanium screw
<b>Biocompatible Titanium</b>	(Ti-6Al-4V ELI) from CARPENTER Co. guarantees high-durability	<b>Groove line</b>	Enhanced adhesion after cementing zirconia
<b>Single and bridge case</b>	Available single and bridge types of abutments	<b>Gold tin-coating</b>	Allowing improvement on aesthetic points and also identifying the perfect fit between abutment and fixture
<b>Anti rotation surface</b>	A plane surface on the abutment prevents rotation between zirconia and abutment	<b>Compatibility</b>	Various compatible Implant systems

## LA Multibase Features



3 kind of cutting line provides awesome utility for customers.

Each height has its own dedicated library.

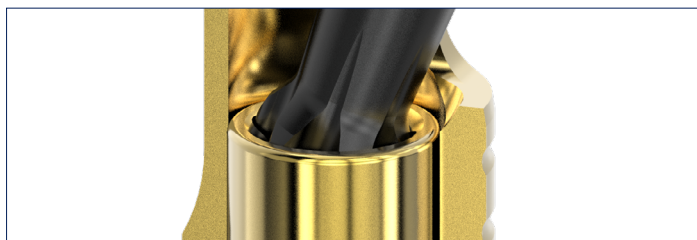

Minimized abrasion of driver & screws by using unique designed driver.

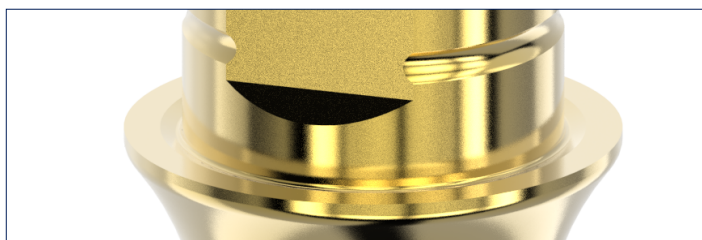

Natural notch will give better retention with cement space.



Two angle screws are provided when buying LA abutments.

Even genuine straight screws are compatible with the abutment.

## Product List

<Includes 2 screws>

Company	Implant system	Platform	Code
Osstem	TS	3.0 / 3.5 (Mini)	LA2-SUM-H2
		4.0 / 4.5 / 5.0 (Regular)	LA2-SUM-N2
Dentium	Super-Line	3.7 / 4.0 / 4.5 (Universal)	LA2-SURO-H2
			LA2-SURO-N2
Megagen	AnyRidge	3.5 / 4.0 / 4.5 (Universal)	LA2-DER-H2
			LA2-DER-N2
Straumann	Bone Level	3.3 (NC)	LA2-MARR-H2
			LA2-MARR-N2
			LA2-BLM-R2
		4.1 / 4.8 (RC)	LA2-BLM20-R2
			LA2-BLM-N2
			LA2-BLR-R2
Zimmer Biomet	Tapered Screw-Vent	3.5	LA2-BLR20-R2
			LA2-BLR-N2
			LA2-TSV3-H2
			LA2-TSV320-H2
Astra Tech	EV	3.6 (Purple)	LA2-TSV3-N2
			LA2-AEV36-T2
		4.2 (Yellow)	LA2-AEV36-N2
			LA2-AEV42-T2
Camlog	Conelog	3.3	LA2-AEV42-N2
		3.8 / 4.3	LA2-CN33-E2
		5.0	LA2-CN3843-E2
Bego	Bego	3.7	LA2-CN50-E2
Biohorizon	3.0	3.0	LA2-BEGO37-H2
			LA2-BH30-H2
Neoss	ProActive	3.5 / 4.0 / 4.5 / 5.0 / 5.5	LA2-BH30-N2
			LA2-NEP-T2

## Driver List

Recommended angle of use up to 25°

Abutment Driver	Type	Length	Code
Universal Round hexagon	Square	13mm	ASDUVR
		20mm	ASDUVL
	Ratchet	13mm	ALDUVR
		20mm	ALDUVL
	LAB DRIVER (DYNAMIC)	-	RBLACK